



## THE KONA MODEL

1 Bedroom, 1 Bathroom, Full Kitchen, Sq. Ft: 399



## 399 SQ FT HOME, SLEEPS 2 ADULTS

### Dimensions

Units are 11'1" wide by 40'8" long.

### Appliances - Summit

24" wide refrigerator/freezer

4-burner cook top

Microwave

Dishwasher

Stack washer/dryer

### Additional Features

Fully covered front deck

Glass door entryway

Outdoor deck off the back with glass door that opens to deck

Bedroom sized for queen bed, two side tables

Conduit ready for cable and cat six internet

Insulation Values: R-22 Roof | R-19 Floors | R-11 Walls

### Turnkey

All units come "turnkey" with all appliances and hardware included.

All you will need is furniture.

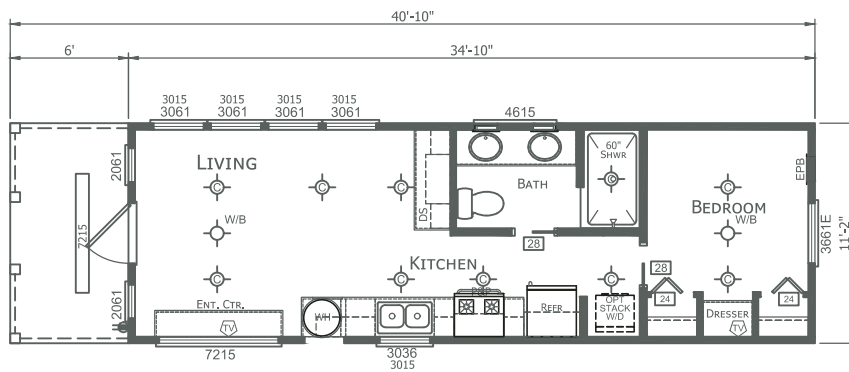

8207 Canoga Avenue, Austin, TX 78724  
(844) 503-3271 • VillageFarmAustin.com





## THE KONA MODEL

1 Bedroom, 1 Bathroom, Full Kitchen, Sq. Ft: 399

### Value Model Guide

#### Champion Home Builders

#### Athens Park Select Series

Base price .....	\$50,995
Whit shiplap ceiling throughout .....	\$1,995
Covered porch .....	\$692
Black rebar on handrail .....	\$100
Plank flooring throughout .....	\$638
Outside water faucet .....	\$40
Linen cabinet above commode .....	\$145
76" Entertainment center .....	\$75
High definition counter tops throughout .....	\$250
18" ceramic backslash - kitchen .....	\$100
House sink with faucet .....	\$495
60" 1/2 glass tile shower package .....	\$1,675
(3) Rolling 24" barn doors .....	\$1,155
4"x6" Plank beams ceiling .....	\$480
White painted ceiling .....	\$100
Azure 50 wall mounted fireplace .....	\$1,095
Ceiling fan with light .....	\$440
(4) recessed LED can lights .....	\$200
OSB Exterior stained lap siding .....	\$1,295
36 x 80 Door with blinds .....	\$195
24" stackable washer/dryer .....	\$1,650
Prep for washer/dryer .....	\$195
Stainless steel appliance package .....	\$1,595
Clay vinyl low e windows .....	\$295
6" White shiplap interior wall - bedroom .....	\$360
2-Head ductless AC/heat split unit .....	\$2,995

**TOTAL OPTIONS .....** \$18,255

**TOTAL PARK PACKAGE .....** \$11,650

**MOVE IN READY PRICE .....** \$81,900

**NOTE:** These prices are only good for our current inventory homes. Please add \$3,000-\$5,000 for Special Retail Orders. Prices, terms, specifications, and availability are subject to change without notice. Elevation and floor plans are artist renderings and are subject to change. See sales member for more details. 1/2019

